



FRONT RUNNER

**NISSAN NV200
TRACKS**

ENG

TRNV001



INSTALL TIME: 15 mins

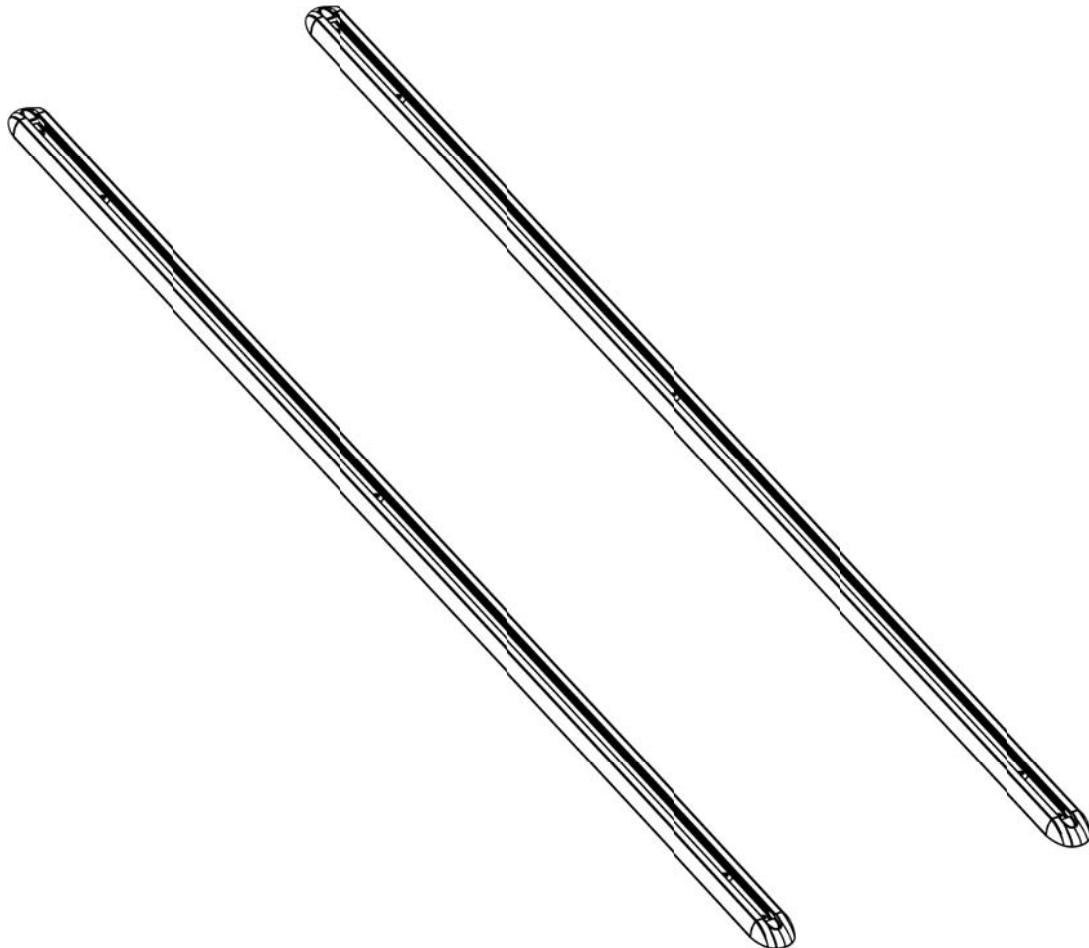

IMPORTANT WARNING!

IT IS CRITICAL THAT ALL FRONT RUNNER PRODUCTS BE PROPERLY AND SECURELY ASSEMBLED AND ATTACHED TO YOUR VEHICLE. IMPROPER ATTACHMENT COULD RESULT IN AN AUTOMOBILE ACCIDENT, AND COULD CAUSE SERIOUS BODILY INJURY OR DEATH TO YOU OR TO OTHERS. YOU ARE RESPONSIBLE FOR ASSEMBLING AND SECURING ALL FRONT RUNNER PRODUCTS TO YOUR VEHICLE, CHECKING THE ATTACHMENTS PRIOR TO USE, AND PERIODICALLY INSPECTING THE PRODUCTS FOR ADJUSTMENT, WEAR, AND DAMAGE. THEREFORE, YOU MUST READ AND UNDERSTAND ALL OF THE INSTRUCTIONS AND CAUTIONS SUPPLIED WITH YOUR FRONT RUNNER PRODUCT PRIOR TO INSTALLATION OR USE. IF YOU DO NOT UNDERSTAND ALL OF THE INSTRUCTIONS AND CAUTIONS, OR IF YOU HAVE NO MECHANICAL EXPERIENCE AND ARE NOT THOROUGHLY FAMILIAR WITH THE INSTALLATION PROCEDURES, YOU SHOULD HAVE THE PRODUCT INSTALLED BY A PROFESSIONAL INSTALLER OR OTHER QUALIFIED PERSONNEL.

1

GET ORGANIZED...

Here is what you are looking at: Please note that only the right hand side has been shown.

Item #	Quantity	Description
1	6	M8 x 20 BUTTON HEAD BOLT
2	2	TRACK
3	4	END CAP
4	2	PROTECTIVE STRIP

You will need:

- 5 mm Hex Key
- Rag and some Methylated Spirits/Denatured Alcohol
- Tube of Clear Silicone
- Drill Machine
- 11 mm Drill Bit
- Phillips Screw Driver
- White Marker

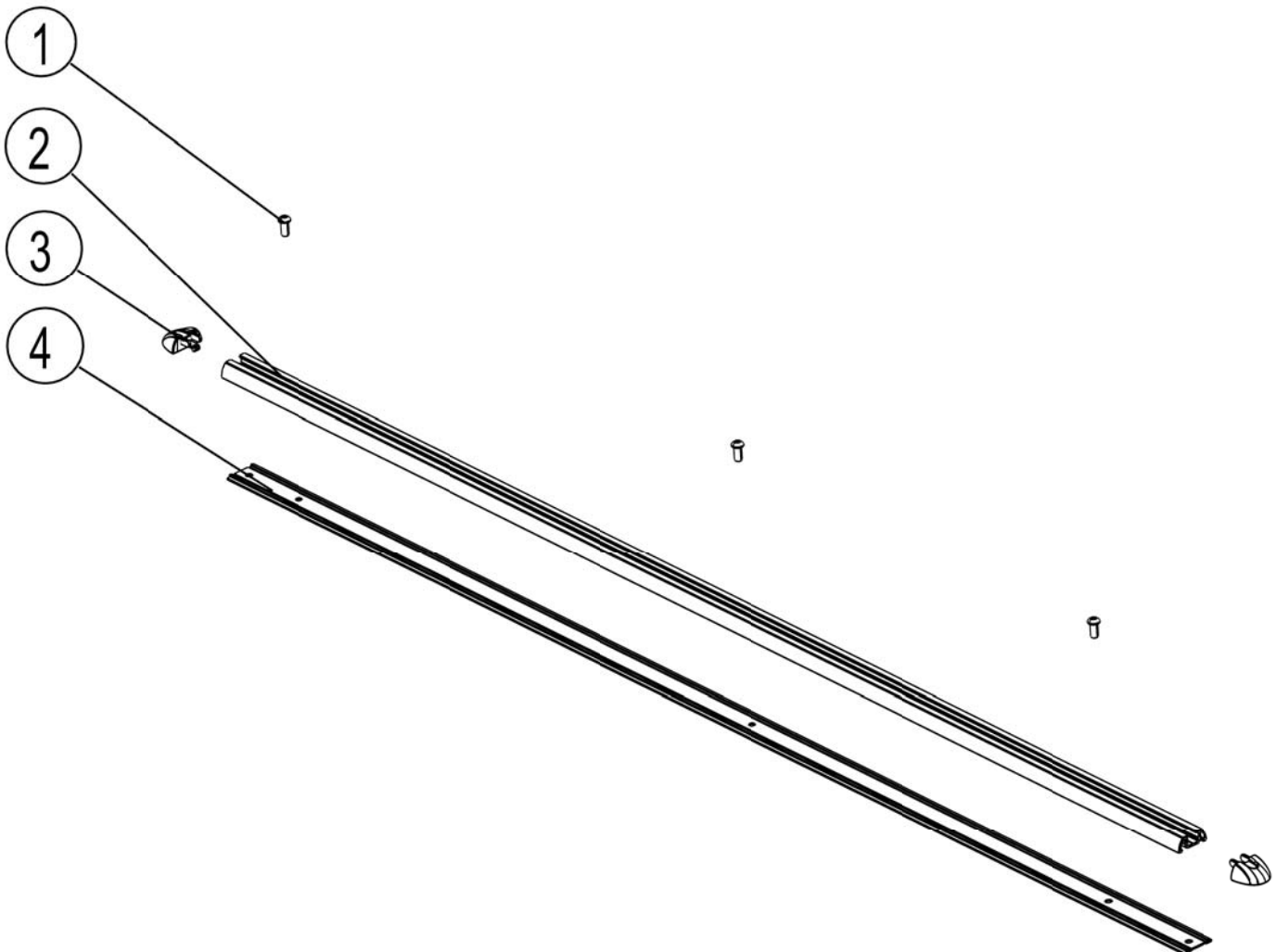

(A) Familiarize yourself with the parts and then step away from the work area and read through these instructions from beginning to end. Take a moment as a little prep now may save you a lot of time later.

2 INSTALL THE TRACKS

- (A) Ensure that the Protective Strip (Item 4) is lined up with the edge of the Track (Item 2). Using a white marking pen, mark the position of the three Oval Holes in the Track onto the Protective Strip. Starting at one end, slide the Protective Strip out from under the Track (as shown) to expose your markings. Using a drill machine, 11 mm drill bit and a suitable surface to drill on, carefully drill a 11 mm hole in the Protective Strip on each of your markings. Once complete, slide the Protective Strip back and across to expose your markings on the other side of the Track and drill the remaining 11 mm holes. Slide the Protective Strip back into position, lining up the holes in the Track up with the holes in the Protective Strip.

Ensure Protective Strip is lined up with Track

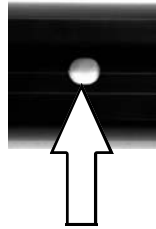

Mark all the Oval Holes (Three per Track) positions onto Protective Strip.

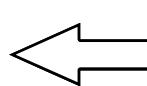

Slide Protective Strip out to expose markings



Drill a 11mm Hole on each marking.

- (B) Using a Phillips screwdriver remove the front, middle and rear plugs from the roof as indicated by the arrows to expose the threaded mounting points.

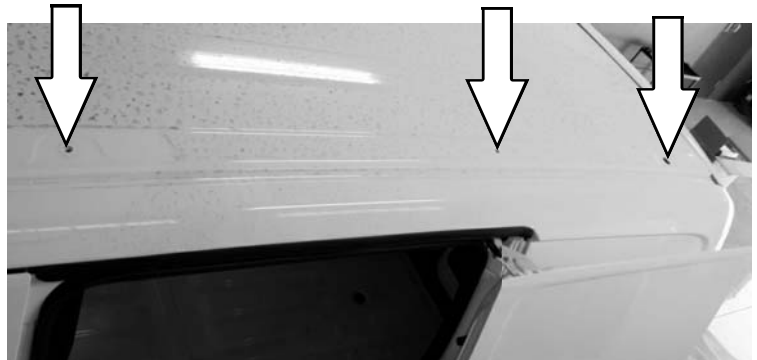

- (C) Clean the area around each mounting point from Step 2B with a rag and some methylated spirits/denatured alcohol. Place a small amount of silicone over each of the mounting points as shown.



2 INSTALL THE TRACKS

- (D) Place the Tracks onto the vehicle, lining up the holes in the Track with the mounting points in the vehicle's roof. Starting from the front of the vehicle, secure the Track to the vehicle using the M8 x 20 Button Head Bolts (Items 1) supplied. When securing the rear of the Track, you will need to pull the Track towards you (as shown) in order to line up the hole in the Track with the mounting point in the vehicle.



- (E) Once you have inserted all the required components for the accessories to be mounted to the Track, slide and clip an End Cap on to end of each Track as shown.

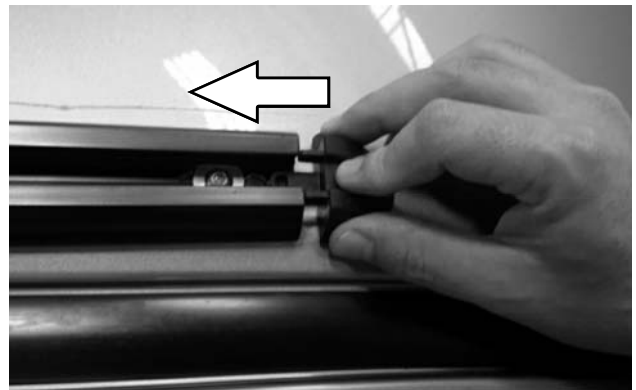

- (F) Congratulations, you have completed your installation. Take a step back and admire your work. Good Job!



3 INSTALL OTHER VEHICLE AND RACK ACCESSORIES

- (A) Now's the time to visit your favorite Front Runner dealer in person or online.