



# START HERE!

## READ ME FIRST

Don't be a hero and muscle through this without first reading these fitting instructions! Improper installation of this gear may void certain aspects of your warranty.

Before you begin, take a moment and open all your Front Runner rack kit boxes and gather the assembly instructions for the various components.

A complete kit will contain:

1. A Front Runner Mounting System specific to your vehicle
2. A Front Runner Rack Tray or Load Bar Slats

This document will guide you through the assembly of the mounting system and assist you in fitting the roof rack tray or load bars to your specific vehicle.

Please refer to the next page for a list of all the components, quantities and tools required.

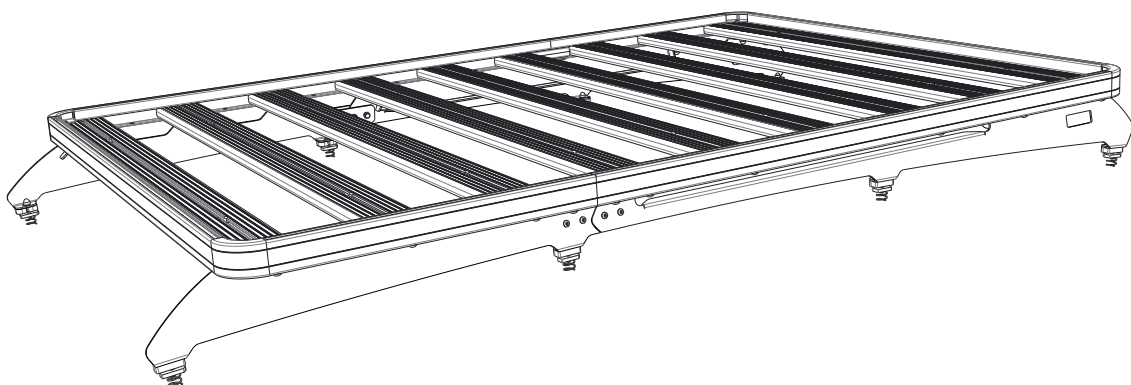

### IMPORTANT WARNING!

IT IS CRITICAL THAT ALL FRONT RUNNER PRODUCTS BE PROPERLY AND SECURELY ASSEMBLED AND ATTACHED TO YOUR VEHICLE. IMPROPER ATTACHMENT COULD RESULT IN AN AUTOMOBILE ACCIDENT, AND COULD CAUSE SERIOUS BODILY INJURY OR DEATH. YOU ARE RESPONSIBLE FOR ASSEMBLING AND SECURING ALL FRONT RUNNER PRODUCTS TO YOUR VEHICLE. CHECKING THE ATTACHMENTS PRIOR TO USE, AND PERIODICALLY INSPECTING THE PRODUCTS FOR ADJUSTMENT, WEAR AND DAMAGE. THEREFORE YOU MUST READ AND UNDERSTAND ALL OF THE INSTRUCTIONS AND PRECAUTIONS SUPPLIED WITH YOUR FRONT RUNNER PRODUCT PRIOR TO INSTALLATION OR USE. IF YOU DO NOT UNDERSTAND ALL OF THE INSTRUCTIONS AND CAUTIONS, OR IF YOU HAVE NO MECHANICAL EXPERIENCE AND ARE NOT THOROUGHLY FAMILIAR WITH THE INSTALLATION PROCEDURES, YOU SHOULD HAVE THE PRODUCT INSTALLED BY A PROFESSIONAL INSTALLER OR OTHER QUALIFIED PERSONNEL.

# 1

## GET ORGANIZED

Here is what you are looking at for FAFE001

### IN THE BOX

1	2 X	Rear Foot Rail; 1xLH, 1xRH
2	2 X	Front Foot Rail; 1xLH, 1xRH
3	8 X	M6x16 Button Head
4	8 X	M6x12x1 Stainless Steel Flat Washer
5	8 X	M6 Nyloc Hex Nut
6	16 X	M6 Nut Cap
7	12 X	M8x20 Hex Bolt
8	12 X	M8x16x1.6 Flat Washer
9	12 X	M8 Nyloc Hex Nut
10	12 X	M8 Nut Cap
11	8 X	M6x30 Hex Bolt
12	8 X	M6 Spring Washer
13	8 X	M6x19x1 Stainless Steel Flat Washer

### IN THE BOX CONTINUED

14	2 X	Splice Plate
15	8 X	Foot Spacer
16	8 X	M6 Channel Nut
17	1 X	Protective Rubber Strip 250mm Long

### TOOLS NEEDED



13mm  
10mm



Measuring  
Tape



Allen Key  
4mm



Sealant

FIGURE 1.1

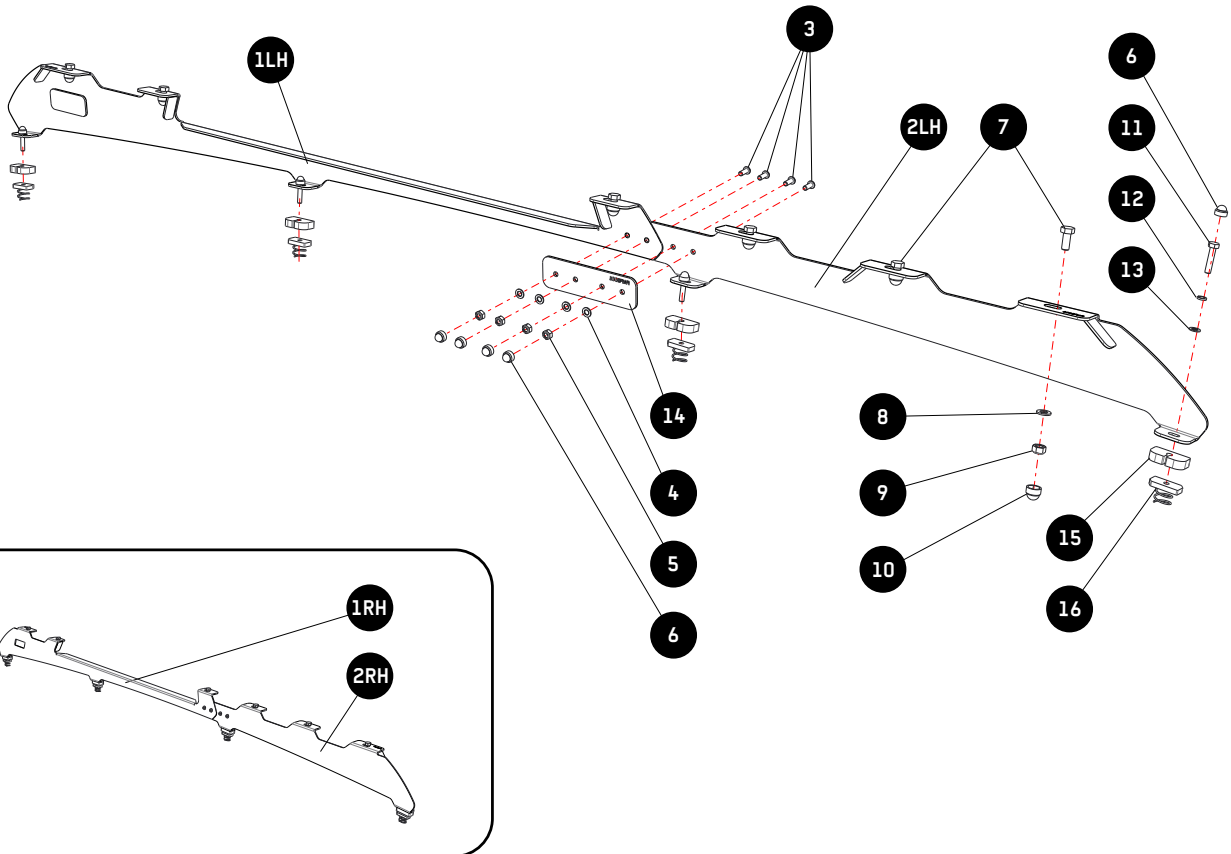

## 2 FIT AND SECURE

2.1 To achieve this installation you will need to remove the Interior roof lining and then the factory roof rails. 

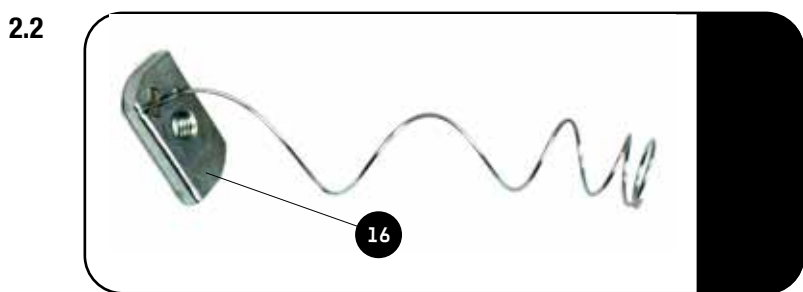



 Prepare the channel nuts (item 16) by stretching out the spring to use it as a handle.

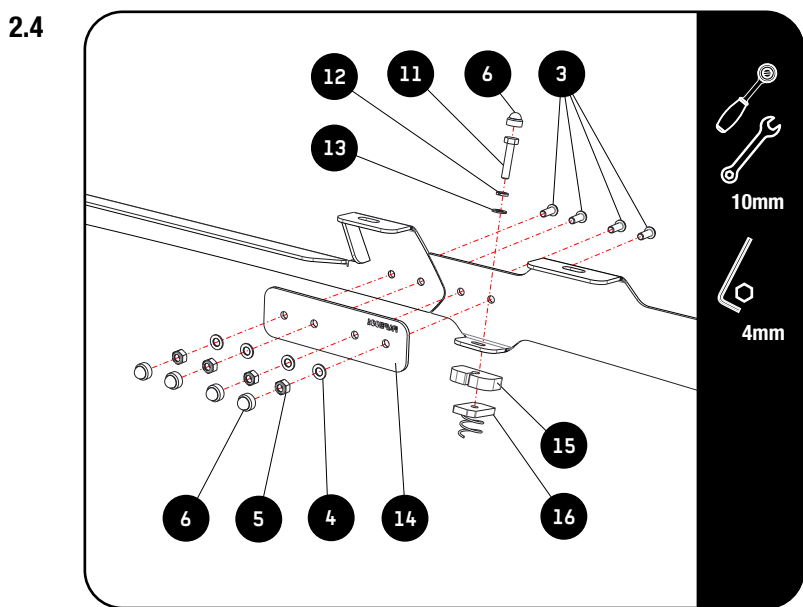

 Cut a 20mm piece of item 17. Remove backing and place under item 15.  
Place a bead of sealant in and over each hole in the roof, then place a spacer over each hole (item 15).



 Join the two halves of the foot rails with the supplied splice plate (Item 14). Fasten as shown with items 5, 4 and 3.  
Now place the assembled foot rail onto the spacers and fasten with items 11, 12, 13 and 16.

2.5 Tighten all the nuts and bolts securing the foot rails to the vehicle's roof. Place a M6 Nut Cap (Item 6) over each of the M6 Nuts and Hex Bolts. 

### 3 FIT AND SECURE

3.1 Refer to RRSUNI when assembling your Slimline II Tray.

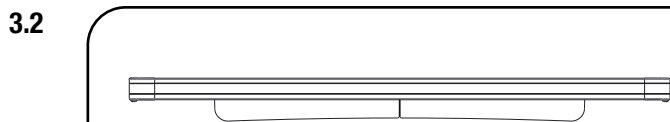

Make sure that the wind deflector is installed before you proceed to the next step.

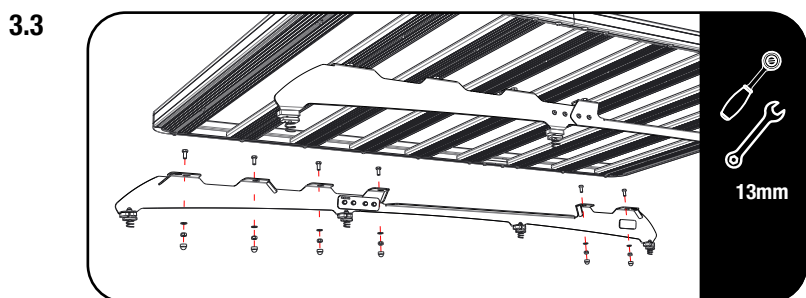

Fit your roof rack to the foot rails with items 7, 8 and 9.

3.4 Centre the rack and tighten fully. Use the supplied M8 nut caps (Items 10) to finish off the nuts.

### 4 COMPLETION



Congratulations. You did it. Take a step back and admire your work!

### 5 INSTALL OTHER VEHICLE AND RACK ACCESSORIES

Now's the time to visit your favorite Front Runner Dealer in person or Online.